

TYPE CEL 50-N-16-903
CODE 73373
WEIGHT 114 g
DESCRIPTION N male - DIN 7/16 male

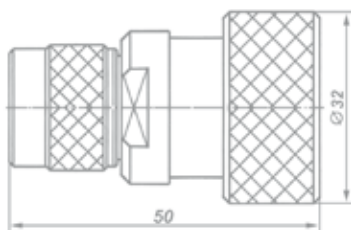

TYPE CEL 50-N-16-904
CODE 94617
WEIGHT 113 g
DESCRIPTION N male - DIN 7/16 female

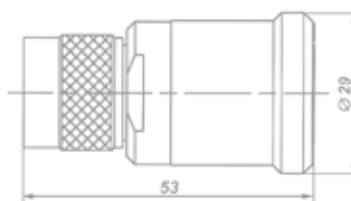

TYPE CEL 50-N-16-929
CODE 81076
WEIGHT 108 g
DESCRIPTION N female - DIN 7/16 male

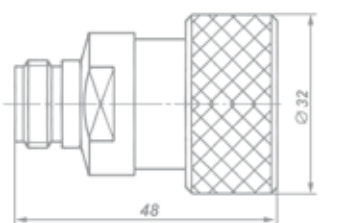

TYPE CEL 50-N-16-902
CODE 94616
WEIGHT 108 g
DESCRIPTION N female - DIN 7/16 female

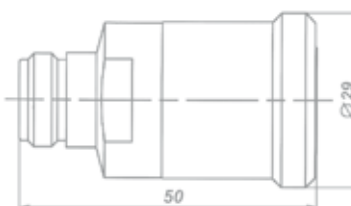

TYPE CEL 50-N-22-908
CODE 67191
WEIGHT 375 g
DESCRIPTION N male - EIA 7/8"
REMARK Inners not included, see details on page 134.

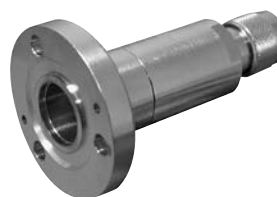
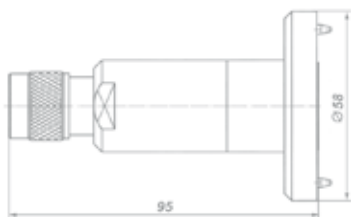

TYPE CEL 50-N-22-905
CODE 64939
WEIGHT 350 g
DESCRIPTION N female - EIA 7/8"
REMARK Inners not included, see details on page 134.

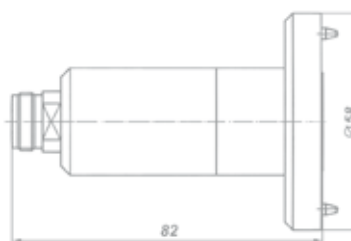

TYPE CEL 50-N-40-909
CODE 66498
WEIGHT 1.130 g
DESCRIPTION N male - EIA 1 5/8"
REMARK Inners not included, see details on page 134.

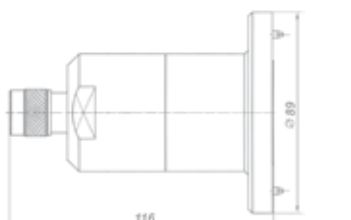

TYPE CEL 50-N-40-906
CODE 64940
WEIGHT 1.165 g
DESCRIPTION N female - EIA 1 5/8"
REMARK Inners not included,
 see details on page 134.

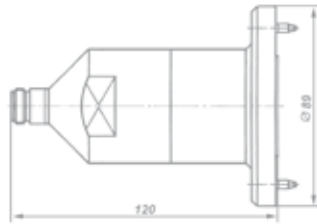

TYPE CEL 50-N-80-907
CODE 81895
WEIGHT 3.100 g
DESCRIPTION N female - EIA 3 1/8"
REMARK Inners not included,
 see details on page 134.

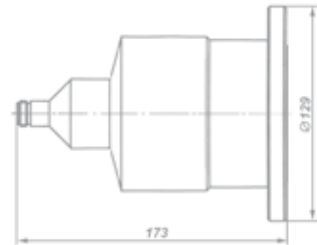

TYPE CEL 50-N-105-911
CODE 82517
WEIGHT 4.790 g
DESCRIPTION N female - EIA 4 1/2"
REMARK Inners not included,
 see details on page 134.

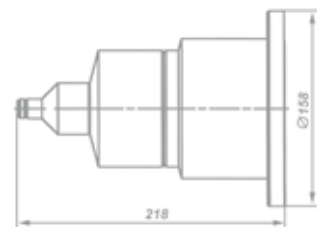

TYPE CEL 50-16-22-930
CODE 64938
WEIGHT 292 g
DESCRIPTION DIN 7/16 male - EIA 7/8"
REMARK Inners not included,
 see details on page 134.

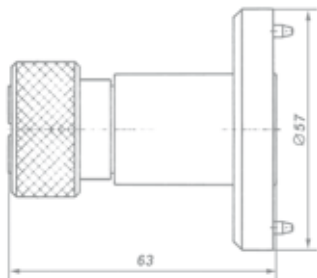

TYPE CEL 50-16-22-923
CODE 64937
WEIGHT 298 g
DESCRIPTION DIN 7/16 female - EIA 7/8"
REMARK Inners not included,
 see details on page 134.

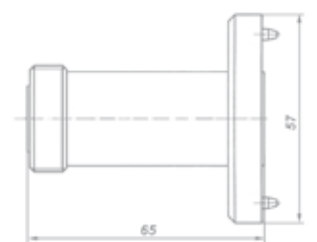

TYPE CEL 50-16-22-921
CODE 91592
WEIGHT 250 g
DESCRIPTION DIN 7/16 female - EIA 7/8" male

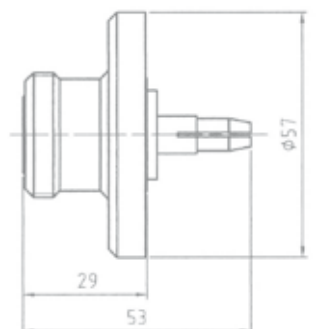

TYPE CEL 50-16-40-931
CODE 67136
WEIGHT 1.149 g
DESCRIPTION DIN 7/16 male - EIA 1 5/8"
REMARK Inners not included, see details on page 134.

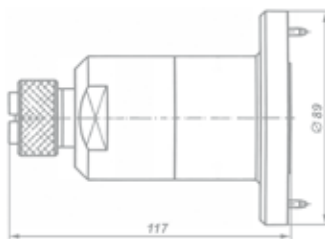

TYPE CEL 50-16-40-924
CODE 65194
WEIGHT 1.138 g
DESCRIPTION DIN 7/16 female - EIA 1 5/8"
REMARK Inners not included, see details on page 134.

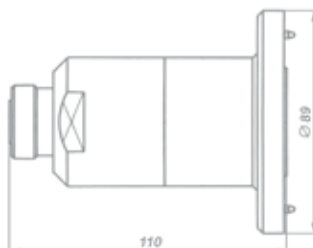

TYPE CEL 50-22-40-941
CODE 64934
WEIGHT 1.296 g
DESCRIPTION EIA 7/8" - EIA 1 5/8"
REMARK Inners not included, see details on page 134.

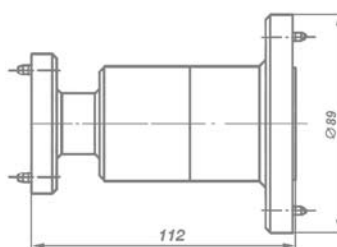

TYPE CEL 50-22-40-947
CODE 96764
WEIGHT 843 g
DESCRIPTION EIA 7/8" male - EIA 1 5/8" male

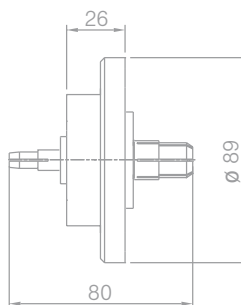

TYPE CEL 50-22-80-942
CODE 69251
WEIGHT 3.930 g
DESCRIPTION EIA 7/8" - EIA 3 1/8"
REMARK Inners not included, see details on page 134.

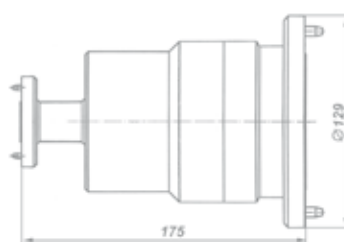

TYPE CEL 50-40-80-951
CODE 64935
WEIGHT 3.500 g
DESCRIPTION EIA 1 5/8" - EIA 3 1/8"
REMARK Inners not included, see details on page 134.

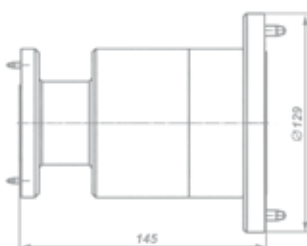

TYPE CEL 50-40-80-953
CODE 91148
WEIGHT 1.780 g
DESCRIPTION EIA 1 5/8" male - EIA 3 1/8" male

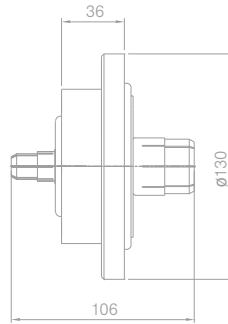

TYPE CEL 50-40-155-954
CODE 72185
WEIGHT 6.320 g
DESCRIPTION EIA 1 5/8" - EIA 6 1/8"
REMARK Inners not included, see details on page 134.

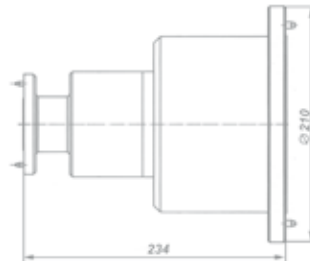

TYPE CEL 50-80-105-961
CODE 64936
WEIGHT 6.650 g
DESCRIPTION EIA 3 1/8" - EIA 4 1/2"
REMARK Inners not included, see details on page 134.

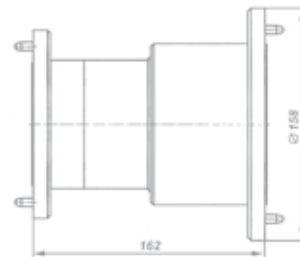

TYPE CEL 50-80-105-962
CODE 94354
WEIGHT 3.000 g
DESCRIPTION EIA 3 1/8" male - EIA 4 1/2" male

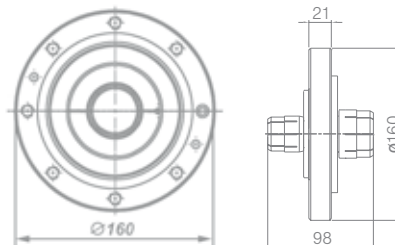

TYPE CEL 50-80-155-963
CODE 66775
WEIGHT 9.540 g
DESCRIPTION EIA 3 1/8" - EIA 6 1/8"
REMARK Inners not included, see details on page 134.

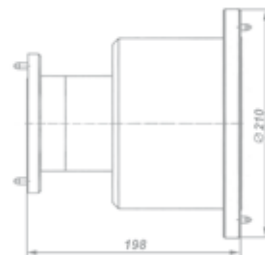

TYPE CEL 50-105-155-967
CODE 98784
WEIGHT 7.500 g
DESCRIPTION EIA 4 1/2" - EIA 6 1/8"

